

V4 ANCILLARIES

V4_SLRd

SERVICE LINE RELIEF & ANTI- CAVITATION

The V4 service line relief valve is used to limit the pressure in individual service lines and provide anti-cavitation protection in circuits with overrun situations to maintain oil in the actuators.

The valve is mounted onto the service port face of a "Z" type valve section using four cap screws. The body has a cavity for each service line. This will accept one of four cartridges, relief, anti-cavitation, relief and anti-cavitation or a blanking cartridge.

Relief valves are pre-set by Hy-Pro, but are fully adjustable retrospectively using the socket screw located under the cap nut. The Hy-Pro service line relief valves and anti-cavitation valves can be used on manual, cable and solenoid operated sections.

Description

The body is machined to accept one of four cartridge options for each service line. The cartridges are relief, anticavitation, relief and anticavitation and blanking cartridge. The relief valves are adjustable.

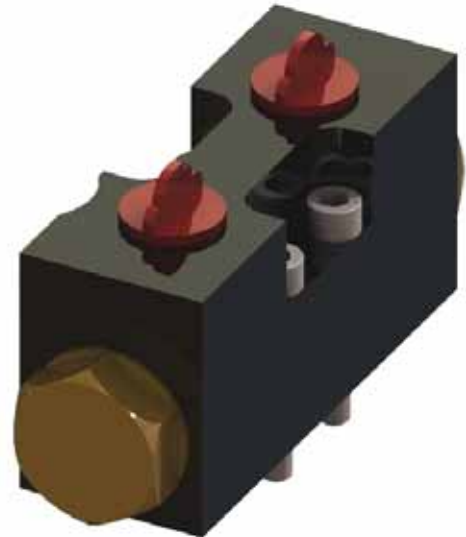

Application

Used to protect one or both service lines from being over pressurized, it is effective when the main spool is selected or in neutral. The anti-cavitation cartridge allows oil to be drawn into the service line should the demand over take the pump supply.

Features

- Fast responding, adjustable direct acting relief valve.
- Large capacity anti-cavitation
- Compact construction.
- Relief and anti-cavitation in each port option.
- Hardened relief and anti-cavitation pistons for long life.

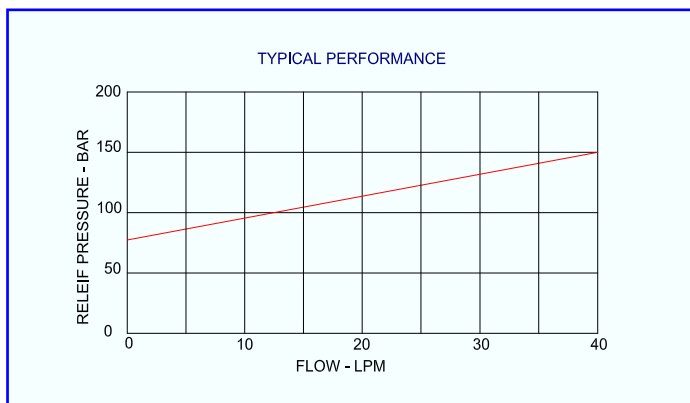

V4 ANCILLARIES

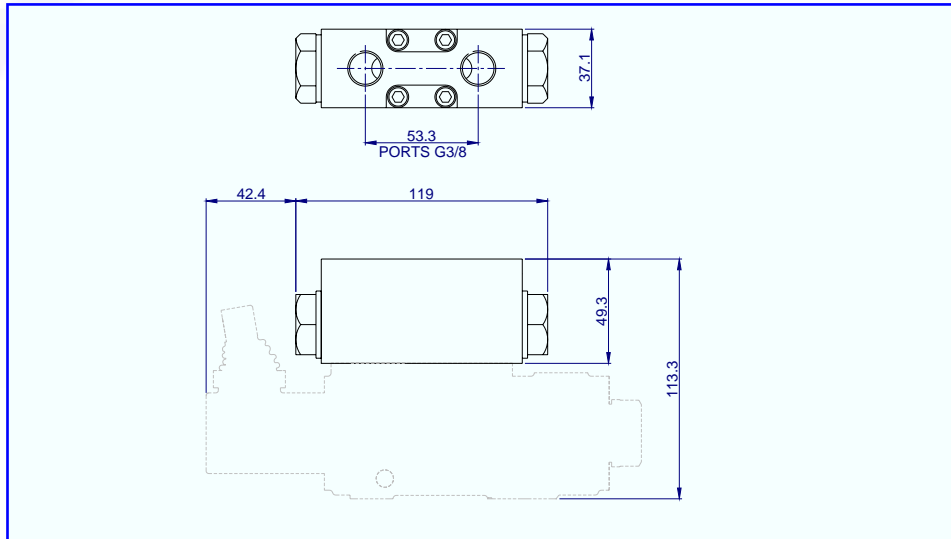

Service
Line Relief Valve
Specification

Performance

Rated flow	40 l/min
Maximum pressure service	250 bar
Maximum back pressure - outlet port	25 bar
Relief valve range	20 bar to 205 bar
Anticavitation	0.5 bar
Temperature rating minimum	-20°C
Temperature rating maximum	+65°C

Recommended Oil

Mineral based hydraulic	ISO VG37
Filtration minimum	25 micron

Materials

Body - Aluminium	BS 1490
External plating - zinc chromate	BS 1706 Zn3
Seals	PTFE & Nitrile
Cap screw torque	8.0 Nm

Mounting interface

Z type

Weight

SLR 140/140	0.53 kg
-------------	---------

