

## V5-60 SERIES CONNECTOR

Hy-Pro series adapter plates are designed to be fitted between two valve sections, connecting in series the actuators that they control. Series adapter plates are often used to synchronize two hydraulic motors where the return oil from one is fed to the inlet of the second.

The series adapter plate effects only the valve sections immediately upstream and downstream of its position in the valve bank. Other sections remain connected in parallel. When using the series adaptor plate, consideration must be given to upstream sections. This is because the normally open tank gallery in the valve bank is pressurized when the series connected actuators are on load. To allow for this, specially designed inlet covers are available.



These contain a separate tank port for draining the relief valve.

Special provision has also to be made for ancillary valves when used with series-connected valve banks. In such cases, customers are advised to discuss their circuit design with Hydraulic Projects.

### Description

This intersection connects upstream tank galleries to the pressure galleries of the downstream section enabling the oil to power a second service or pump flow.

### Application

Used where two or more services are required to operate simultaneously with differing loads. Often used to synchronize two hydraulic motors.

### Features

- Used with standard sections.
- Converts both manual and solenoid sections.

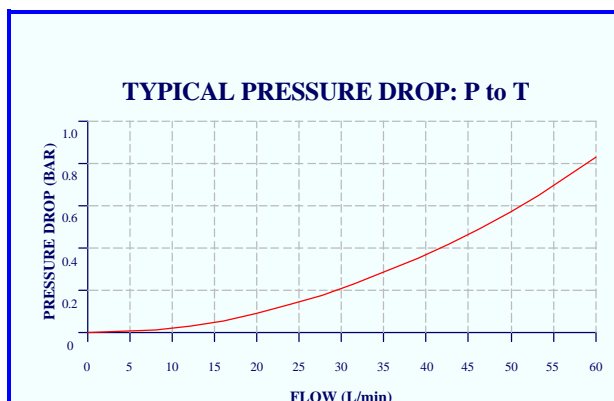

SC

INSTALLATION DETAILS

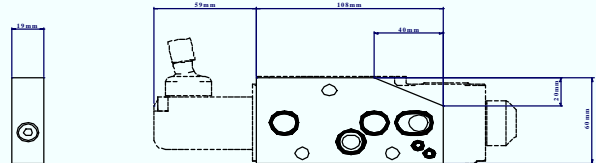

**Technical Data**

**Performance**

Rated flow	60 l/min
$p$ at rated flow P to T	0.8 bar
Temperature rating minimum	-20 °C
Temperature rating maximum	+65 °C

**Recommended Oil**

Mineral based hydraulic	ISO VG37
Filtration (minimum)	25 micron

**Materials**

Aluminium	BS1490
-----------	--------

**Weight**

0.3kg

CIRCUIT DIAGRAM

