

Hy-ProDrive

Marine Steering Technology
By Hydraulic Projects Ltd.

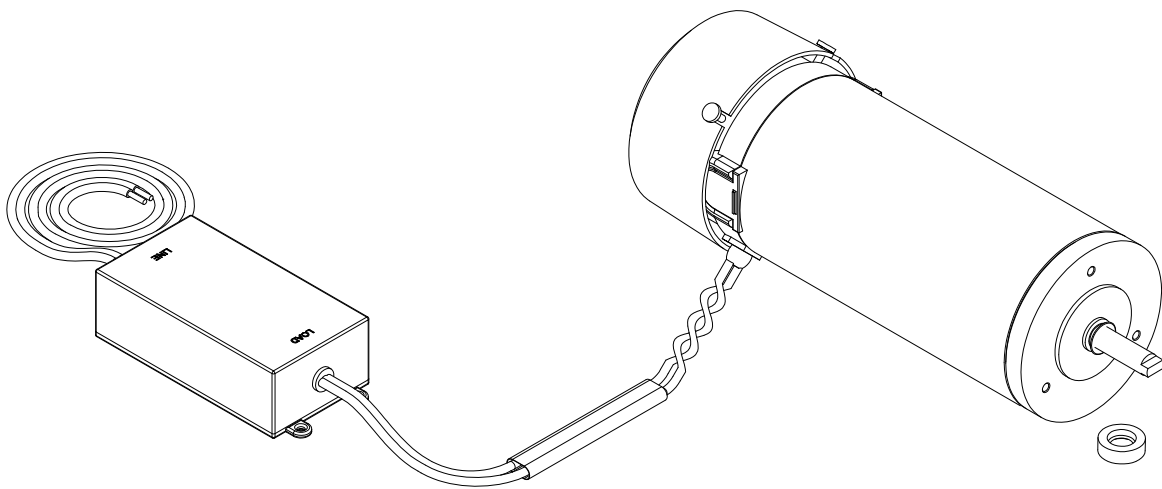

R2240-sk 25

Motor kit installation instructions for
PC25 constant running pumps.

B6030-m02 ISS.01

"K:\11 Product Documentation & Labels\1 Manuals & Enclosures\Customer Documentation\
Hypro\B6030-m02-R2240-sk PC25 MOTOR KITS.pdf"

The information in this manual was, to the best of our knowledge, correct when it went to press and Hydraulic Projects Ltd cannot be liable for any inaccuracies or omissions. There may also be differences between the specifications in the manual and the product as a result of ongoing development for which we accept no liability.



This motor is NOT suitable for installation in vessels with petrol engines or in petrol tank spaces.

This equipment meets the latest EMC (Electromagnetic Compatibility) standards required for use in the recreational marine environment. In order to ensure conformance and to prevent interference with electronic systems the unit must be properly bonded to earth and the supply cables screened.

DO NOT FLASH TEST

1) BEFORE STARTING -

- i) Removing and replacing the motor will result in the loss of a small amount of oil from the hydraulic system. It may be necessary to either drain the tank or work with the motor up to minimise the loss.
- ii) Check that the voltage indicated on the body of the motor matches the one that you are replacing.
- iii) Isolate the power supply to the auto-pilot to prevent accidental operation.
- iv) Disconnect the motor power leads from the vessels wiring.

2) TOOLS REQUIRED

4mm hex / Allen key

5mm hex / Allen key

Torque wrench

Loctite 222 or equivalent medium strength engineering adhesive

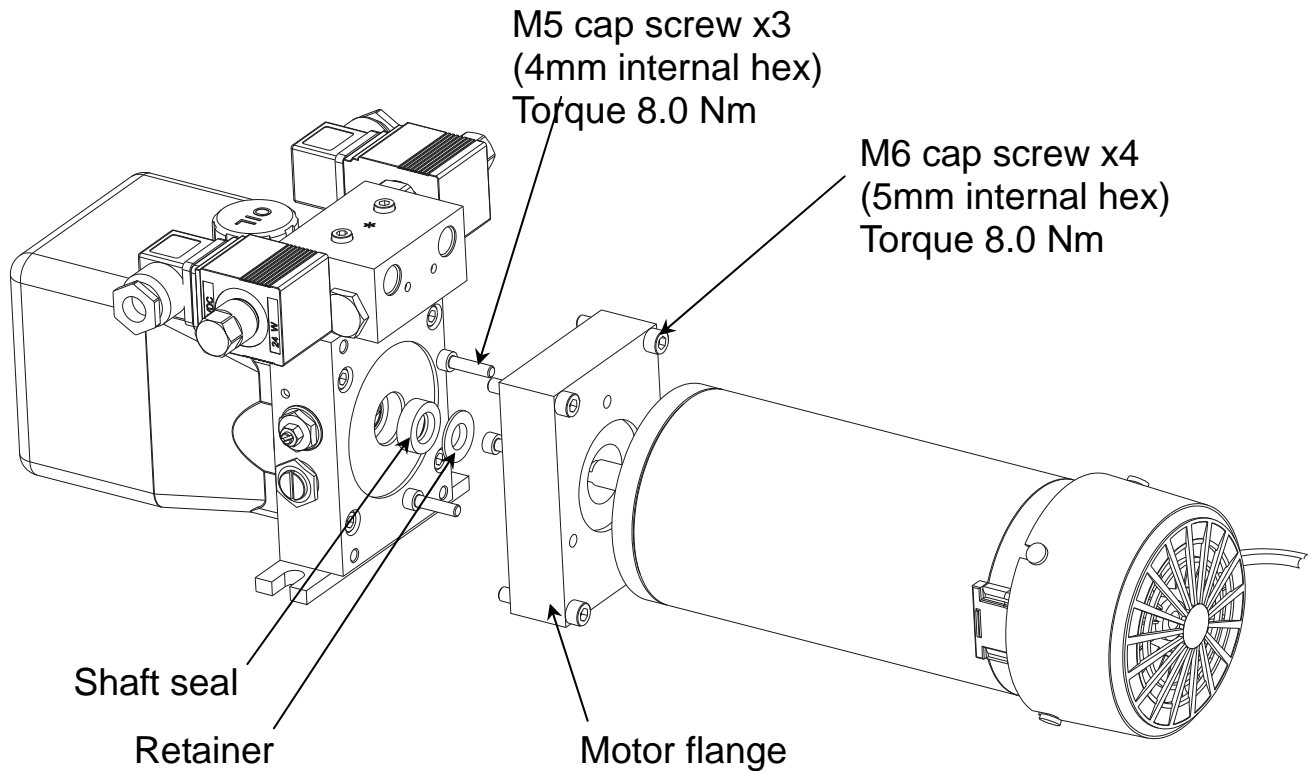

3) INSTRUCTIONS

- i) Undo and remove the 4x M6 cap screws and withdraw the motor and flange and prepare to catch any lost oil. Remove the retainer and carefully prise out the shaft seal using a blunt tool (observe the orientation of both parts).
- ii) On the rear of the motor flange undo and unscrew the 3x M5 cap screws and remove the motor.
- iii) Fitting the replacement motor is a reversal of the removal process. Apply adhesive to all screw threads and torque tighten to the figure shown. Fit the new shaft seal with the lip pointing away from the motor and the retainer with its flat face against the motor. Ensure that the coupling and motor drive tang are aligned before re-fitting. Ensure that the motor shaft and shaft seal are kept free of damage. 
- iv) **IMPORTANT**
Connect the new motor power leads **observing correct polarity**.
DO NOT REMOVE the EMC filter box.
- v) Turn on the auto-pilot power supply and test it functions correctly with new motor.

Hy-ProDrive™

Marine Steering Technology
By Hydraulic Projects Ltd.



Our in-house design and technical teams offer the expertise and support expected of an established world-class manufacturer. Our customers, ranging from the agricultural, transport, rail, fishing, construction and industrial sectors, expect named personal support, excellent quality and a rapid service with full back-up...

....we aim to deliver in full.

Call us today to discuss a bespoke solution from our extensive range or simply for competitively priced spares.

Full technical details of our entire range are available to download from our website

www.hypro.co.uk



Certificate No. 11935